

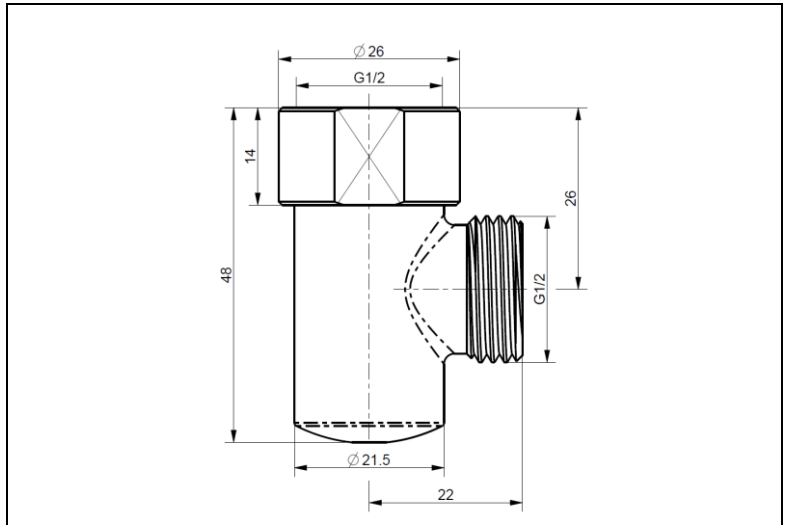

Data sheet

Product: RCM classic drain valve 1/2"



Description:

- Self-draining valve for shower hose
- 1/2" internal thread nut x 1/2" external thread – connection
- Brass chrome plated
- Installation between valve and shower hose

The RCM classic 1/2" drain valve fits all standard shower fittings.

Shower hose drain valves are connected between the faucet and the hose in order to drain the hose after every usage.

Automatic emptying of the tube after closing the valve. The complete discharge can only occur if the hose does not sag. Therefore, a shorter hose and shower holder instead of a shower rod is recommended.

Complies with hospital guidelines Robert Koch Institute RKI.

Certification: KTW, W270

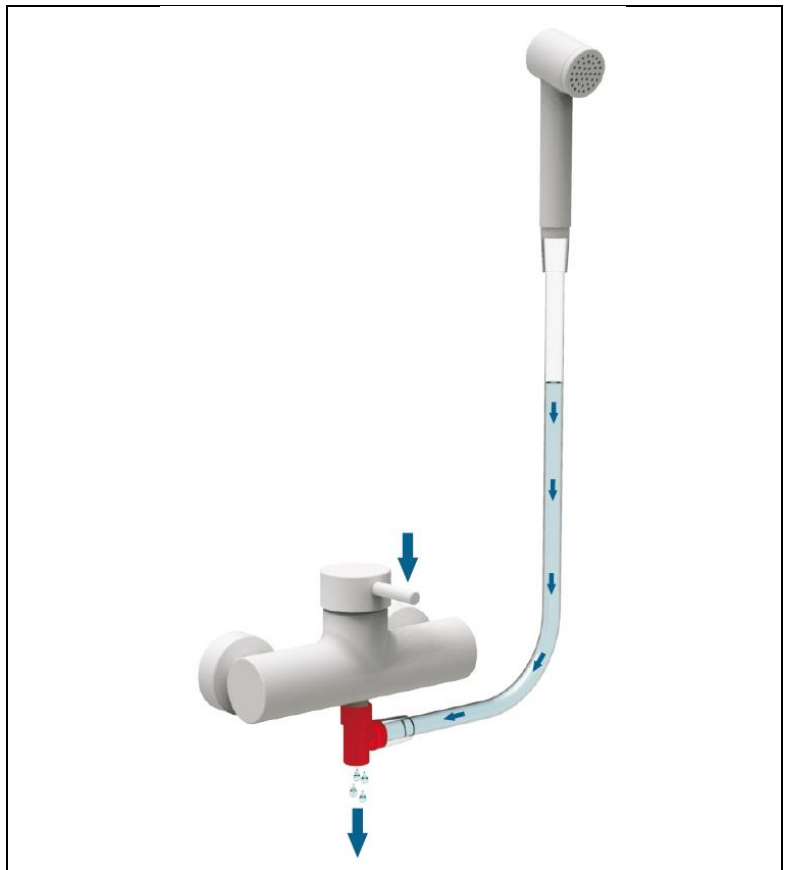

Material:	CW614N
Surface:	Chrome plated
Weight:	75 gramm
Dimensions:	48x33mm
Connection:	External thread 1/2" x internal thread 1/2"
Pressure:	1-10bar
Others:	
Article number:	AREOFLEX.2
Packing:	Single Pack